

FOR  
LEASE

# 354-356 Smoke Tree Business Park

## North Aurora, Illinois 60542

### *Property Information:*

- 4,000 sf Unit
- Zoned B-2
- 2 Dock High Doors
- Great for Sales Office, Light Industrial, and General Business office
- 50% Office 50% Warehouse.
- Minimum Divisible: 2,000 sf



### *Property Highlights:*

Industrial Flex Space in North Aurora, located near I-88 and Route 31 (Lake Street). Convenient to major interstate highways, O'Hare International and Rockford International Airports. 45 minutes to Chicago. Very convenient and reasonably priced. 50% office, 50% warehouse. Ample parking. Rare small warehouse with dock-high doors.

**IMMEDIATELY AVAILABLE**

**PRICE: \$2700/mo Gross**

For more information contact:

John Schutzius

Office: 630-499-9860

Fax: 630-499-9088

Email: [jrs@icricorp.com](mailto:jrs@icricorp.com)

[www.icricorp.com](http://www.icricorp.com)

**Industrial  
Commercial  
Realty &  
Investment**

# INDUSTRIAL COMMERCIAL REALTY AND INVESTMENT

## PROPERTY FACT SHEET

Type of Property:	Industrial	Pin:	15-09-201-013 344-356 Smoke Tree Industrial Park
Address:	354-356 Smoke Tree Business Park, North Aurora, IL 60542		
Total Building Size:	16,200 sf (source: public records)	Lease Type:	Gross
Available Space:	4,000 sq. ft. (two contiguous units)	Lease Price:	4,000 sf : \$2,700/mo
Lot Square Ft:	64,904	Annual Increase:	5.0 %
Office:	50 %	Taxes:	Included in rent
Bathroom:	Three	Common Area Maintenance:	Included in rent
Zoning:	B2	Possession:	Immediate
Present Use:	Vacant	Nearest Interstate:	I-88
Parking:	Ample	Nearest Airport:	Aurora Municipal
Built:	1978	Highway Access:	Route 31, Randall Road
Construction:	1 Story Masonry	Security System:	Tenant Provides
Utilities Onsite:		Roof Age:	6 years
Gas	Tenant Pays	Internet:	Comcast, AT&T
Electric	Tenant Pays	Warehouse Heat:	1 Ceiling Mounted GFA
Water	Tenant Pays	Location:	North Aurora
Waste	Tenant Pays		
Sewer	Tenant Pays		
Heat:	GFA		
HVAC:	Office & Warehouse		
Sprinkler:	None		
Power:	110/220V		
Docks:	None		
Doors:	2 x 8'x8' Dock High Truck Doors		
Clear Height:	16' to deck, 13.5' to joists		
County:	Kane		
Township:	Aurora		

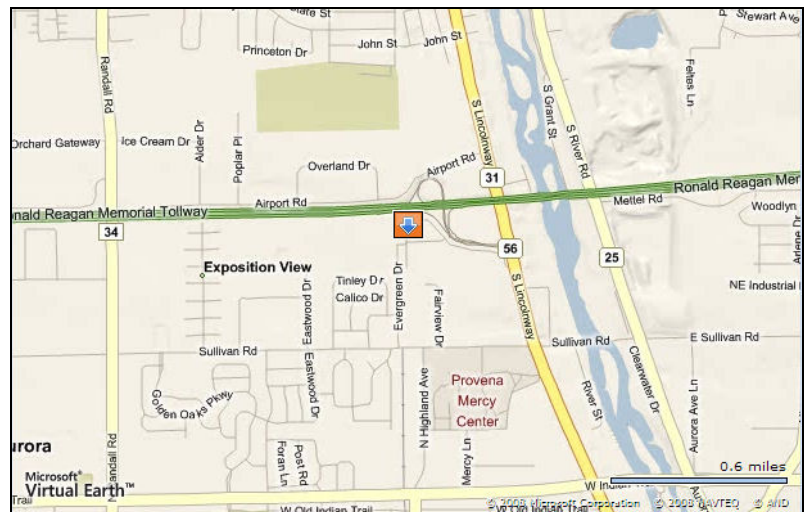

3561 Saint Annes Court, Aurora, IL 60504  
 (630) 499-9860 Fax (630) 499-9088

Information contained herein is from sources deemed reliable. No warranty or representation is made as to the accuracy of the aforementioned information. Price subject to change and listing withdrawal without notice.

### 354 & 356 Smoke Tree Layout

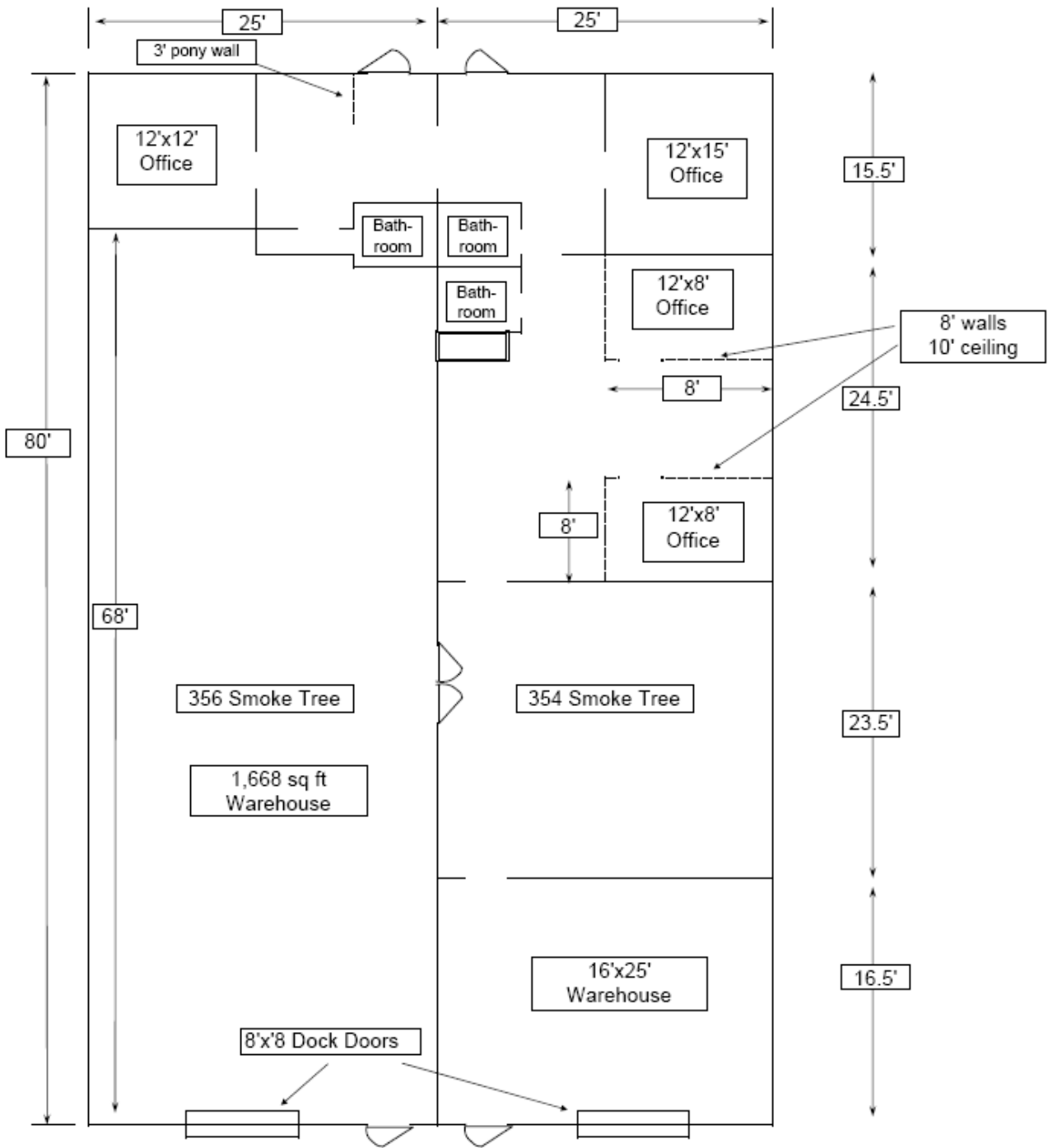

Not to scale. Dimensions are approximate. Though the information contained herein is from what is believed to be accurate sources, Industrial Commercial Realty and Investment Corp makes no warranties, expressed or implied, regarding the accuracy of the information contained herein. Customers should verify all information before executing any binding agreement. Property of Industrial Commercial Realty and Investment Corp. 2010.

